

FRAME SIDE

- Tools Required:  
Screw Driver  
Spirit Level  
Spanner
- 
- 

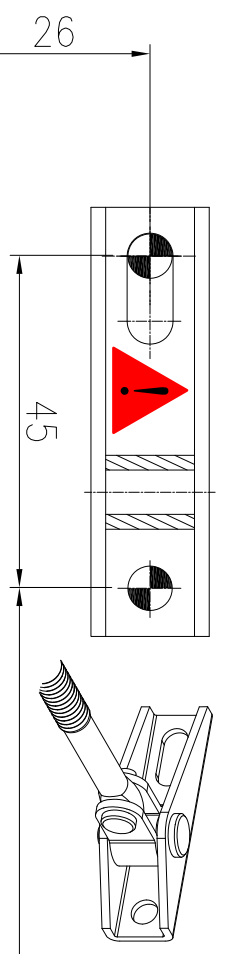

UNION CE3F RACK AND PINION CLOSER  
INSTALLATION INSTRUCTIONS – Regular  
(Fig.1) Right Hand

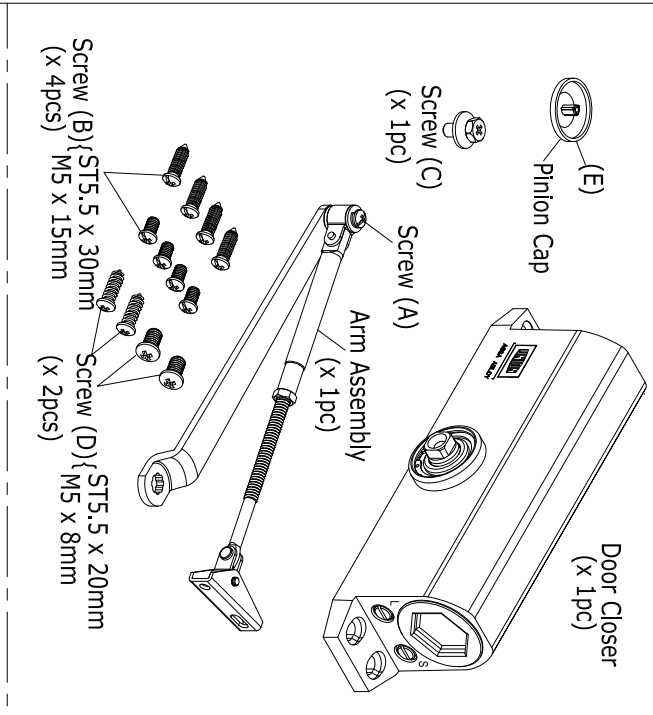
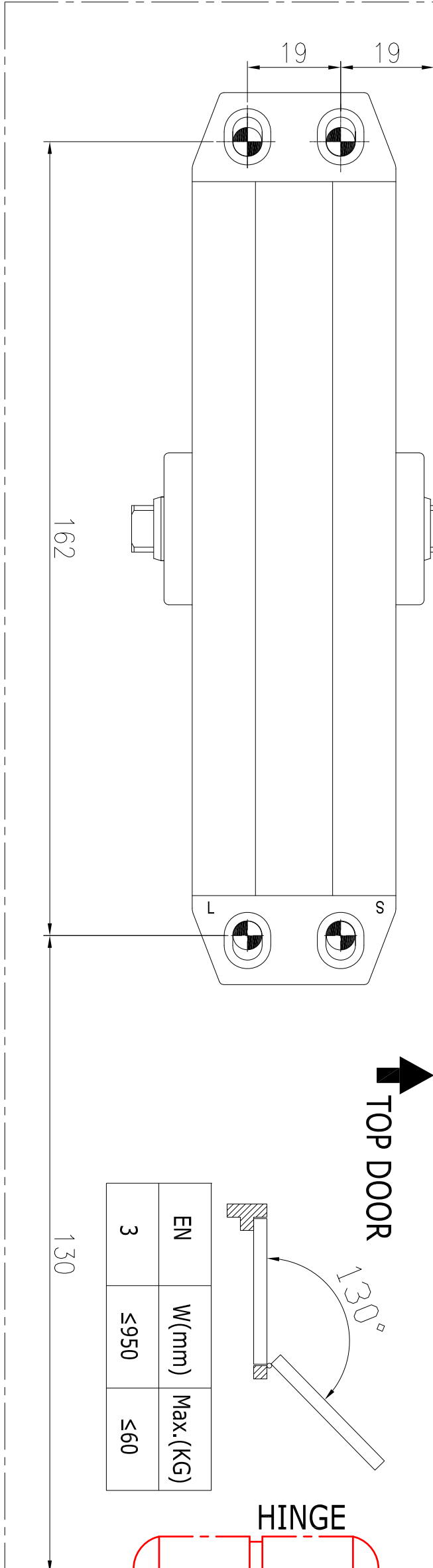

EN	W(mm)	Max.(KG)
3	≤950	≤60

1. Fit template to door, mark holes and remove template.
2. Fit body to door face using 4-off screws (B), use spirit level to get body parallel to door frame.
3. Take arm assembly and remove screw (A). Keep for use later.
4. Take fixed arm shown (X).
5. Fit fixed arm (X) to closer body using screw (C) provided and tighten. Keep fixed arm at 90° to door.

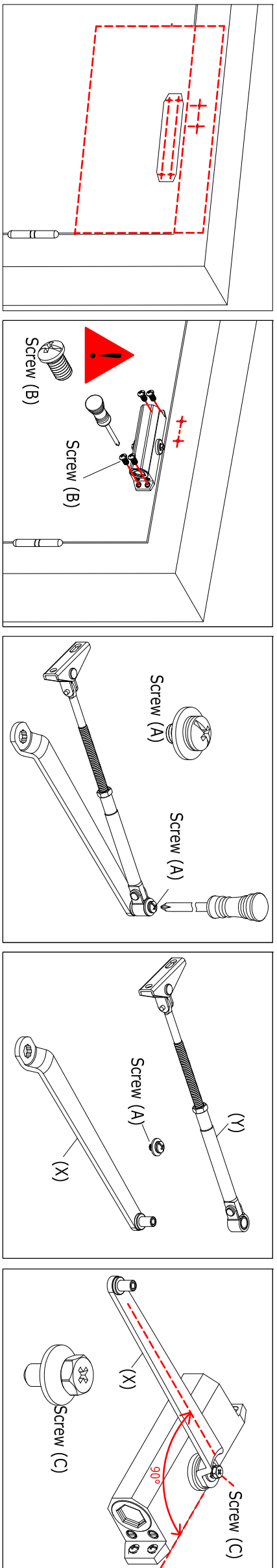

6. Fit adjustable arm to frame using 2-off screws (D).
7. Move fixed arm (X) to meet adjustable arm (Y), changing length of adjustable arm of required. Keep adjustable arm 90° to frame.
8. Tighten screw (A).
9. Use screwdriver to adjust speed and latch valves.
10. Assemble pinion cap (E) onto pinion.

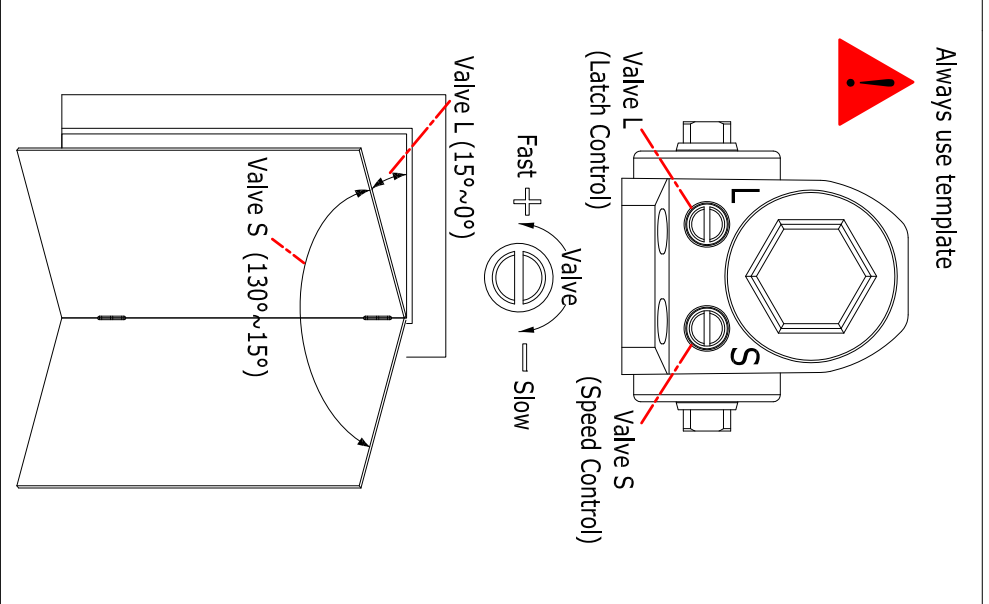
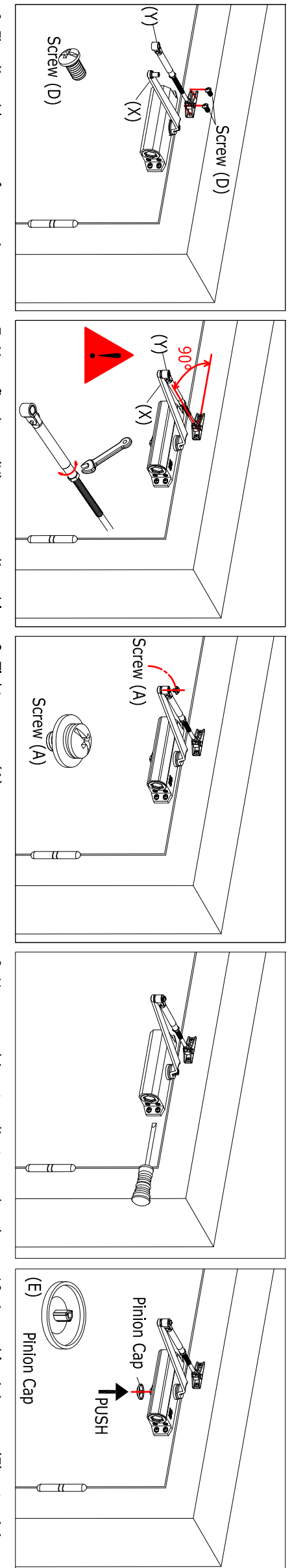



ASSA ABLOY

# UNION CE3F RACK AND PINION CLOSER INSTALLATION INSTRUCTIONS - Regular

(Fig.1) Left Hand

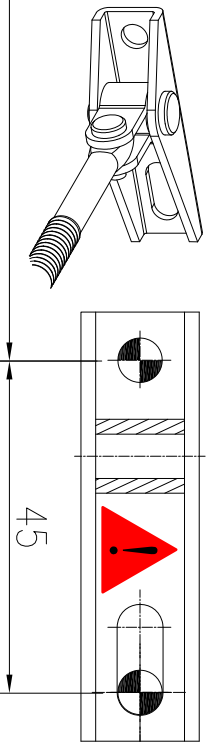

## FRAME SIDE

Tools Required:  
Screw Driver  
Spirit Level  
Spanner

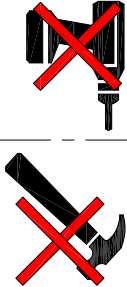

Door Closer  
(x 1pc)

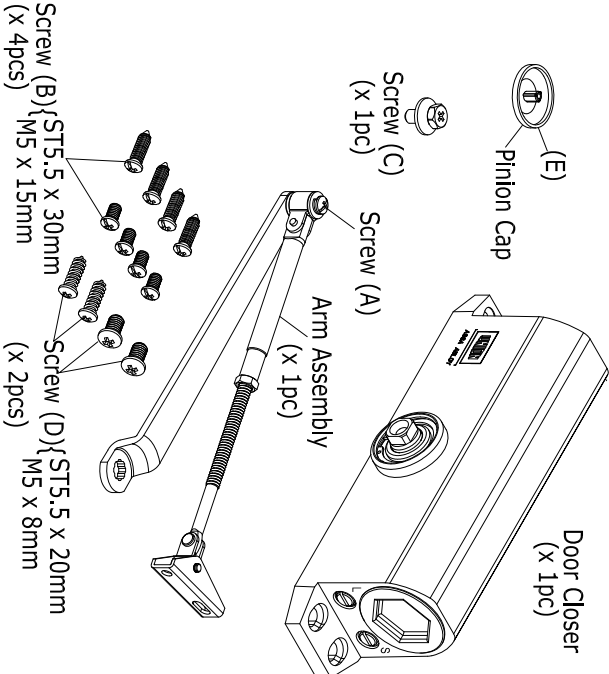

EN	W(mm)	Max.(KG)
3	≤950	≤60

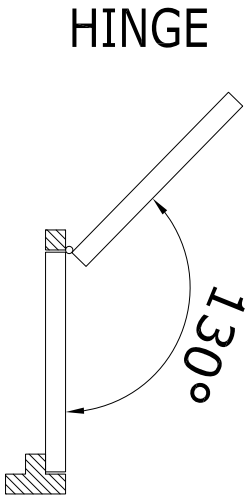

HINGE

130

TOP DOOR

162

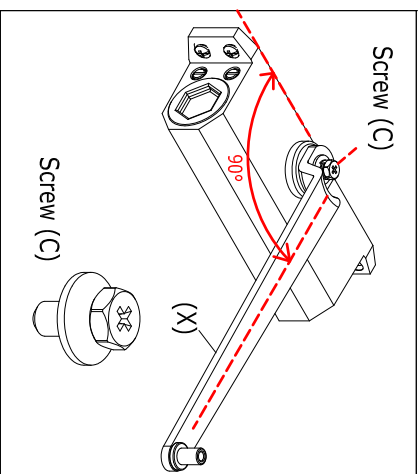
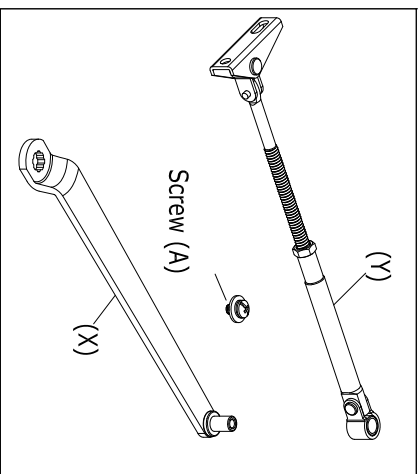
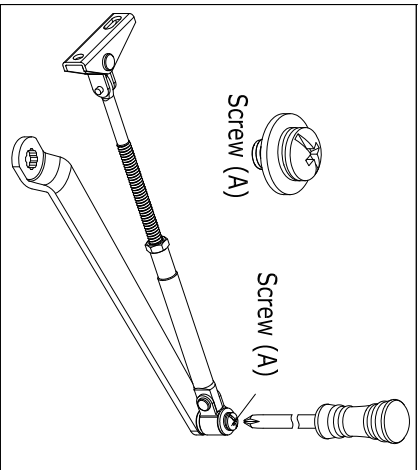
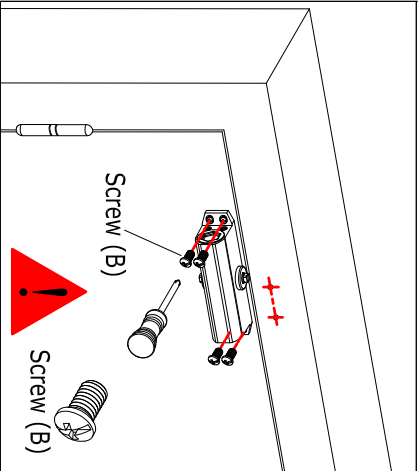
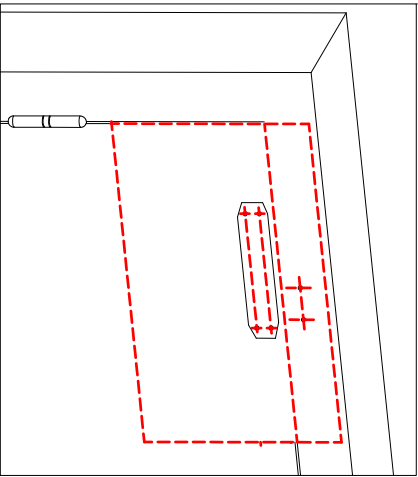

Always use template

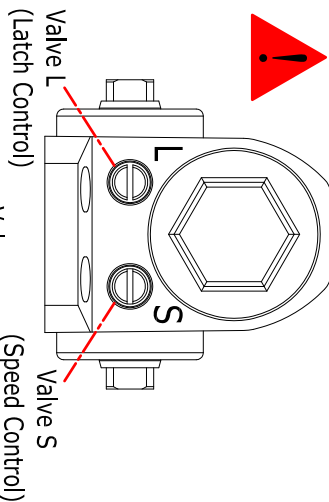

Fast  $\oplus$  Valve  $\ominus$  Slow

Valve L (15°~0°)

Valve S (130°~15°)

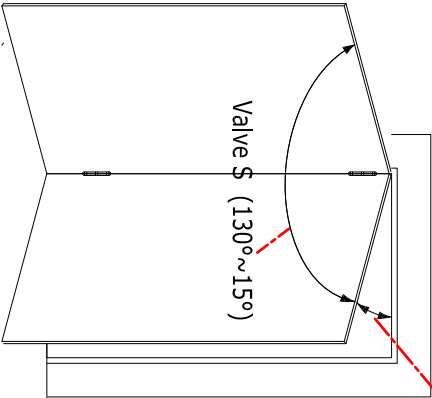

1. Fit template to door, mark holes and remove template.

2. Fit body to door face using 4-off screws (B), use spirit level to get body parallel to door frame.

3. Take arm assembly and remove screw (A). Keep for use later.

4. Take fixed arm shown (X).

5. Fit fixed arm (X) to closer body using screw (C) provided and tighten. Keep fixed arm at 90° to door.

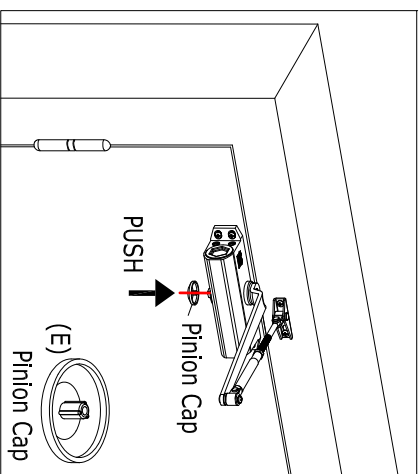
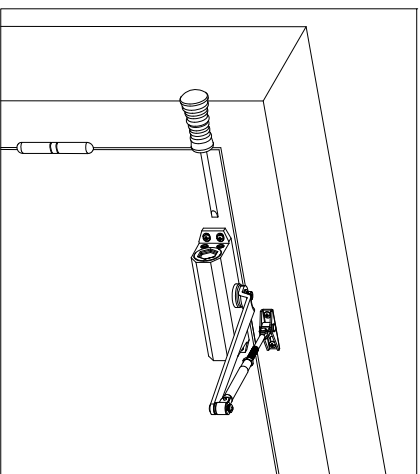
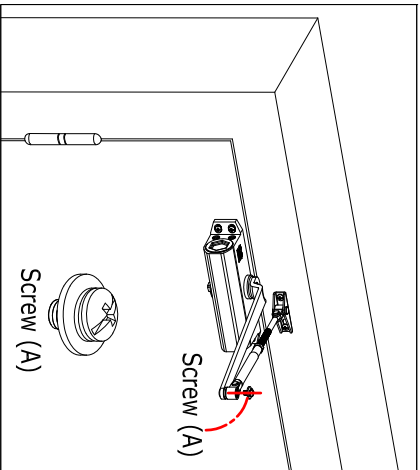
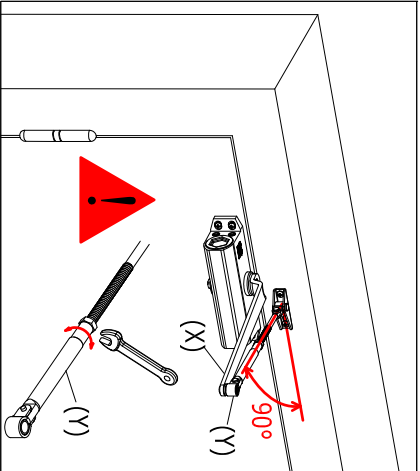
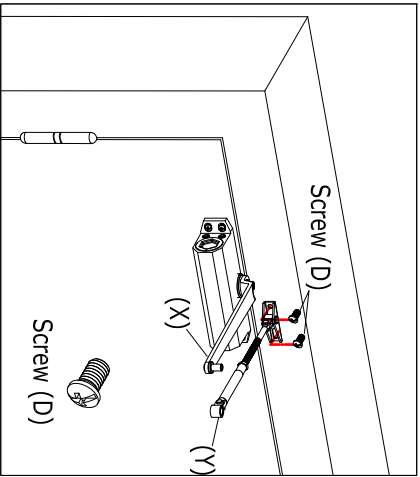

6. Fit adjustable arm to frame using 2-off screws (D).

7. Move fixed arm (X) to meet adjustable arm (Y), changing length of adjustable arm of required. Keep adjustable arm 90° to frame.

8. Tighten screw (A).

9. Use screwdriver to adjust speed and latch valves.

10. Assemble pinion cap (E) onto pinion.

Assembly complete



20160820B-1  
Issue No 1/16